



CLOSING

EC 150 V CLOSING UNIT

Technical Data

Dimensions:	Length:	approx.	1,650 mm
	Width:	approx.	1,135 mm
	Height incl. clip roll:		1,210 mm
	Infeed height:	approx.	750 mm
Product dimensions:	Length:		80-330 mm
	Diameter:		max. 150 mm
Capacity:	max. 50 / 65 or 85 bags / min (depending on the drive unit)		
Controller:	Omron or Omron/Yaskawa		
Frequency controller or Servo inverter:	Hitachi or Omron/Yaskawa		
Power supply:	230/400 Volt / 50 Hz		
Power input:	approx. 2.0 kW		
Compressed Air:	min. 6.0 bar (ISO 8573-1)		
Weight:	500 kg		

Available additional equipment:

- › Hot foil printer ,HPD' for labelling plastic clip tape
- › Shaking base to compact bulk material
- › Guillotine shears
- › Label dispenser

25 A



**GHD Georg Hartmann
 Maschinenbau GmbH**
 Schwalbenweg 24
 D-33129 Delbrück, Germany
 Tel: +49 (0)5250.9843-0
 Fax: +49 (0)5250.9843-33
 Web: www.ghd.net
 E-mail: info@ghd.net



- › EC 101 H
- › EC 101 HS
- › EC 101 IS
- › EC 101 KS
- › EC 104
- › EC 108 SV
- › EC 110
- › EC 130
- › EC 135
- › EC 140
- › EC 140 S
- › EC 150 V
- › EC 155





EC 150 V Closing Unit

This unit is especially suitable for closing bags which are vertically filled with bulk material. It has a built-in, pulse-controlled servo drive and requires no additional synchronization with the prepositioned packing machine. The unit can either be operated in connection with a vertical packaging machine or applied to hand-feed operations. The filled bags are guided by exchangeable buckets to the closing unit and to the outfeed transport.

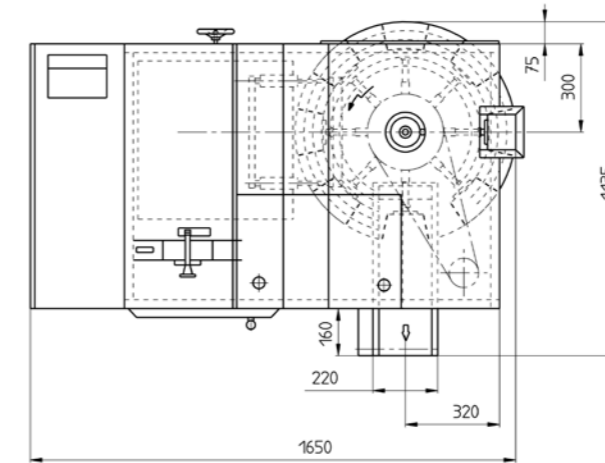
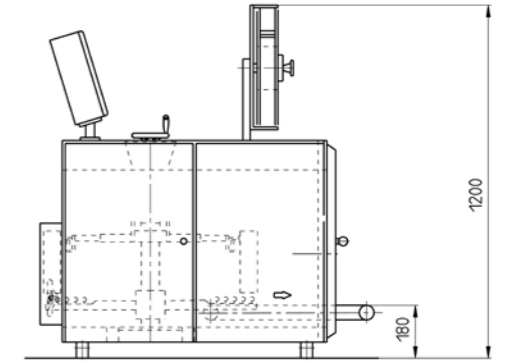
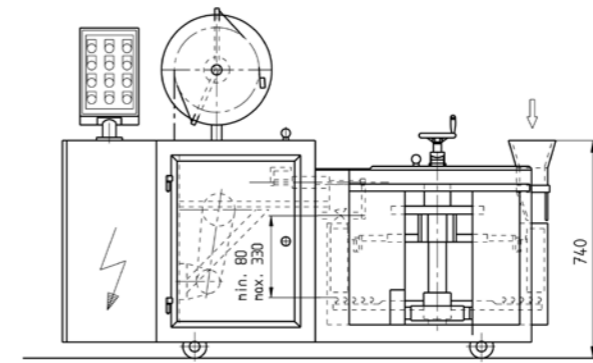

Non-binding suggested set-up drawing.



Closing Unit EC 150 V features

- › Closing of vertically filled bags of bulk material
- › Selection of drive units for different capacities
- › Product-specific exchangeable bucket shaped guides
- › Integrated closing unit
- › Movable on rollers



Optimal:
Driven transport for closed packages.

Optional:
Shaking base to compact bulk material.

Optional: Printing unit
Hot foil printer 'HPD' for labelling plastic clip tape.

